

## 25 dBA Grade Silencers for DE250GC to DE600GC

### STANDARD FEATURES

- End Inlet / End Outlet can be adapted to different exhaust configurations for ease of installation
- Coated with satin black paint rated to 1200°F to retain appearance and corrosion resistance over time
- Connection ANSI flanges are readily adaptable to other hardware providing ease of installation
- Complete with condensate drain and plug
- Aluminized steel all welded construction for heavy duty application and corrosion resistance

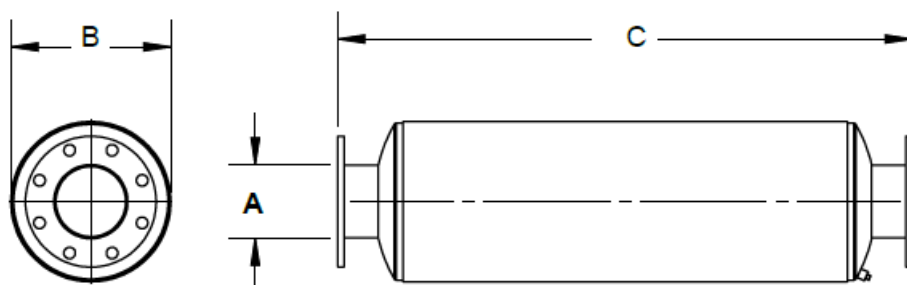

### Residential Silencer – 25dBA

| Generator Model          | Frequency | Sound Attenuation @ 100% Load | Dimensions    |              |                       | Weight |
|--------------------------|-----------|-------------------------------|---------------|--------------|-----------------------|--------|
|                          | Hz        | dBA                           | Length (C) mm | Width (B) mm | Inlet Diameter (A) mm |        |
| <b>DE250GC – DE300GC</b> | 60        | 25                            | 2047          | 453.0        | 157                   | 123.7  |
| <b>DE350GC – DE400GC</b> | 60        | 25                            | 1663          | 554.2        | 219                   | 123.6  |
| <b>DE450GC – DE500GC</b> | 60        | 25                            | 1676          | 554.2        | 211                   | 123.6  |
| <b>DE550GC – DE600GC</b> | 60        | 25                            | 1676          | 554.2        | 211                   | 147.9  |